

## KH60

New

1.8°/step

□ 56mm



### SINGLE SHAFT

#### MODEL

KH6054-B9510□

KH6065-B9510□

### FEATURES

- High Torque (Up at Peak time 15 to 20% higher than our previous products)

### SPECIFICATIONS

STEP ANGLE ° /step	VOLTAGE V	CURRENT A/PHASE	WINDING RESISTANCE Ω/PHASE	INDUCTANCE mH/PHASE	HOLDING TORQUE N · m	ROTOR INERTIA g · cm <sup>2</sup>	MODEL
1.8	3.08	2.8	1.1	3.3	(1.95)	520	KH6054-B9510□
1.8	3.92	2.8	1.4	3.8	(2.4)	680	KH6065-B9510□

Note : KH60 is ready to two mounting dimensions.

End of model name	Mounting hole pitch	Mounting inlay diameter
1	47.14	φ38.1
2	50	φ36

### [GENERAL SPECIFICATIONS]

INSULATION RESISTANCE	500V DC	100MΩ	min. (at normal temp. & humidity, between lead and case)
DIELECTRIC STRENGTH	500V AC	50Hz	1min. (at normal temp. & humidity, between lead and case)
AMBIENT TEMP. AND HUMIDITY	-10°C~+50°C, 5%~95%RH (noncondensing)		
STORAGE TEMP. AND HUMIDITY	-20°C~+70°C, 5%~95%RH (noncondensing)		
TEMPERATURE RISE	70K max (By resistance method)		
POSITION ACCURACY	±10%		

### SPEED-TORQUE CHARACTERISTICS

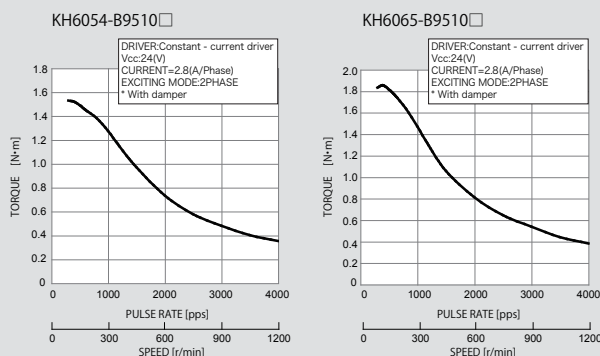

### CONNECTION DIAGRAMS

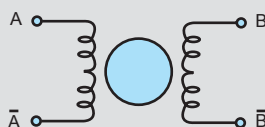

PHASE	A	Ā	B	B̄
COLOR OF LEAD	RED	BLUE	YELLOW	WHITE

CW viewed from rotor shaft when using the following sequence diagram.

#### EXCITATION SEQUENCE

PHASE	1	2	3	4
A	+	+	-	-
B	-	+	+	-
Ā	-	-	+	+
B̄	+	-	-	+

### DIMENSIONS Unit = mm [inch]

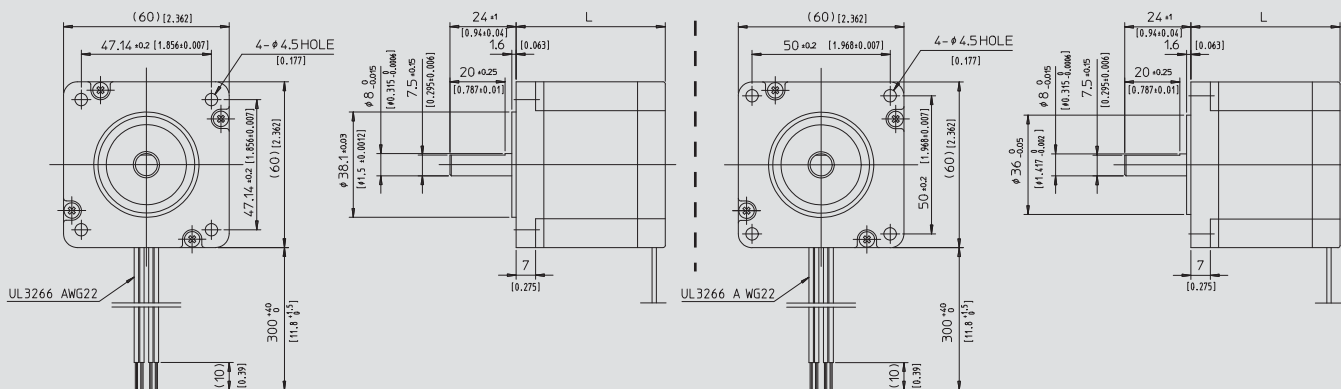

□ End of model name 1

MODEL	L mm (inch)	mass kg (oz)
KH6054	54 (2.126)	0.83 (29.3)
KH6065	65 (2.559)	1.02 (36.0)

□ End of model name 2

**color-technik**  
Antriebstechnik GmbH  
Starkenburgerstr. 6 \* 64546 Mörfelden  
Tel.: 06105 24044 \* Fax: 06105 25593  
info@color-technik.net  
[www.color-technik.net](http://www.color-technik.net)